

Electric MULTI CONTACT GRILLS LARGE



« Heating Element Pack » technology for perfect heat distribution.



Heat insulation of the element for a consistent distribution of heat.



Thermostatic control from 50°C to 300°C for precision cooking.

Characteristics :

- Stainless steel frame
- Cooking plates made from very hard wearing enamelled cast steel and certified for contact with food
- Self-balancing top plate which adapts to food of different thickness
- Adjustable plate pressure
- Protected controls
- Removable tray for waste recovery
- On/off switch built into the control button
- Power light
- Thermostatic control from 50°C to 300°C
- Heating indicator
- CE power cable for 230 V ~ 16A

A new range featuring a double innovation based on the EASY CLEAN System :

- Easy changing of cooking plates for grill or snack functions
- Hotplates dismantle in seconds for easy cleaning in the dishwasher.

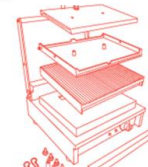
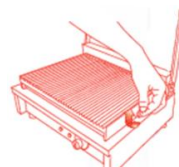
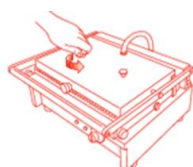

Photos non binding

KRAMPOUZ SAS

Z.A. de Bel Air
29700 Pluguffan - France

Tél. : + 33 2.98.53.92.92
Fax : + 33 2.98.53.92.93

www.krampouz.com
contact@krampouz.com

Griddles	Cooking Surface	Power	Voltage	Weight	Dimensions	Code
Ribbed plate top / Ribbed plate bottom	520 x 230 mm	3760 W	230 / 240 V	39 kg	646 x 379 x 220 mm	GECID5AO
Ribbed plate top / Smooth plate bottom	520 x 230 mm	3760 W	230 / 240 V	39 kg	646 x 379 x 220 mm	GECID5BO
Smooth plate top / Smooth plate bottom	520 x 230 mm	3760 W	230 / 240 V	39 kg	646 x 379 x 220 mm	GECID5CO